

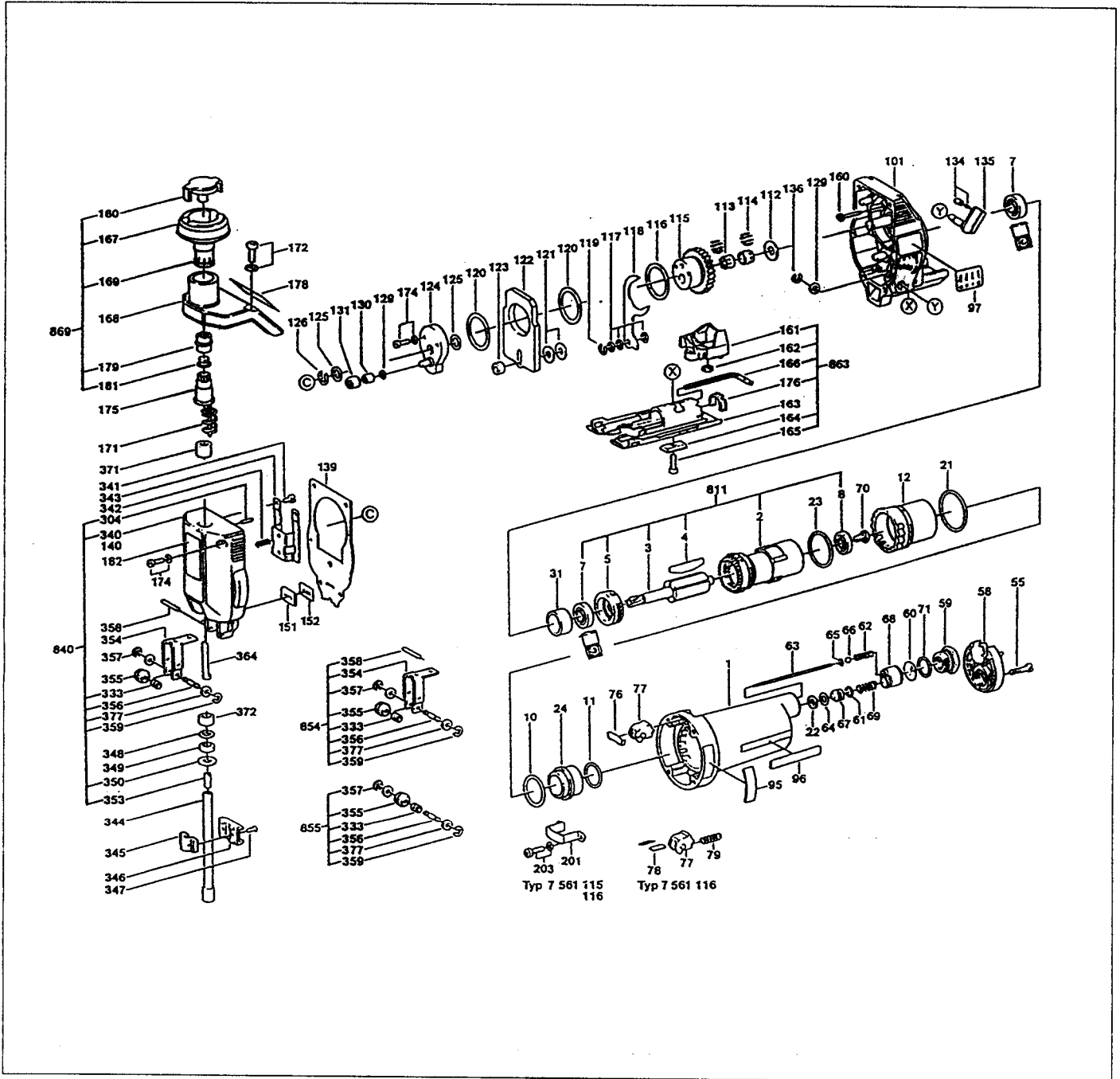

Industrial Airtools

Jig saw RRI-8100 (01)





Industrial Airtools

Jig saw RRI-8100

Ref no	Qty	Part no	Description
01	1	8100-001-00	Motor housing
02	1	8100-002-00	Stator
03	1	8100-003-00	Rotor
04	4	8100-004-00	Rotor blade
05	1	8100-005-00	Bearing flange
07	2	8100-007-00	Deep-groove ball bear
08	1	8100-008-00	Deep-groove ball bear
10	1	8100-010-00	O-ring
11	1	8100-011-00	O-ring
12	1	8100-012-00	Reduction sleeve
21	1	8100-021-00	O-ring
22	1	8100-022-00	Stop disc
23	1	8100-023-00	O-ring
24	1	8100-024-00	Guide sleeve
31	1	8100-031-00	Intermediate ring
55	2	8100-055-00	Self-tapping screw
58	1	8100-058-00	Fitting cover
59	1	8100-059-00	Fitting
60	1	8100-060-00	Filtering screen
61	1	8100-061-00	O-ring
62	1	8100-062-00	Compression spring
63	1	8100-063-00	Straight pin
64	1	8100-064-00	O-ring
65	1	8100-065-00	O-ring
66	1	8100-066-00	Ball
67	1	8100-067-00	Control plunger
68	1	8100-068-00	Piston Housing
69	1	8100-069-00	Compression Spring
70	1	8100-070-00	Hexagon screw
71	1	8100-071-00	O-ring
76	1	8100-076-00	Leaf spring
77	1	8100-077-00	Rock switch
77/1	1	8100-077-01	Control lever

Ref no	Qty	Part no	Description
78	2	8100-078-00	Holding plate
78/1	1	8100-078-01	Center grooved pin
79	1	8100-079-00	Compression spring
82	1	8100-082-00	Intermediate flange
97	1	8100-097-00	Sticker
101	1	8100-101-00	Gear housing
112	1	8100-112-00	Shim
113	2	8100-113-00	Needle roller cage
114	20	8100-114-00	Needle roller
115	1	8100-115-00	Eccentric cog wheel
116	1	8100-116-00	Shim
117	2A	8100-117-00	Shim
117/1	1A	8100-117-01	Shim
118	1	8100-118-00	Fork lever
119	1	8100-119-00	Locking washer
120	2	8100-116-05	Shim
121	1A	8100-121-00	Shim
121/1	1A	8100-121-01	Shim
121/2	1A	8100-121-02	Shim
121/3	1A	8100-121-03	Shim
122	1	8100-122-00	Counterweight
123	1	8100-123-00	Spacer sleeve
124	1	8100-124-00	Eccentric disc
125	1	8100-125-00	Shim
125/1	1A	8100-125-01	Shim
125/2	2A	8100-125-02	Shim
126	1	8100-126-00	Locking washer
129	2	8100-129-00	Shim
129/1	1A	8100-129-01	Shim
129/2	1A	8100-129-02	Shim



Industrial Airtools

Jig saw RRI-8100

Ref no	Qnt	Part no	Description
130	1	8100-130-00	Needle bushing
131	1	8100-131-00	Bearing sleeve
134	1	8100-134-00	Ratchet cap
135	1	8100-135-00	Rotary knob
136	1	8100-136-00	Locking washer
139	1	8100-139-00	Seal
140	1	Pos. 840	Gear cover
151	1	Pos. 351	Gasket
152	1	Pos. 351	Fastening plate
160	4	8100-160-00	Self-tapping screw
161	1	8100-161-00	Closing cover
162	2	8100-162-00	Hexagon nut
163	1	8100-163-00	Foot plate
164	1	8100-164-00	Profile beading
165	1	8100-165-00	Hex-sock head cap screw
166	1	8100-166-00	Offset screwdriver
167	1	Pos. 869	Cap-handle
168	1	8100-168-00	Flanged fitting
169	1	Pos. 869	Handle
171	1	8100-171-00	Compression spring
172	2	8100-172-99	Washer-and-screw assemb.
174	6	8100-174-99	Washer-and-screw assemb.
175	1	8100-175-00	Coupling half
176	1	8100-176-00	Scale plate
178	1	8100-178-00	Sticker
179	1	Pos. 869	Ratchet
180	1	Pos. 869	Push button
181	1	Pos. 869	Retaining piece
182	1	8100-182-00	Sticker
201	1	8100-261-00	Safety device
203	2	8100-262-00	Washer-and-screw assemb.
333	1	Pos. 854	Needle bushing
340	1	Pos. 840	Gear cover

Ref no	Qnt	Part no	Description
341	2	8100-341-00	Thread-forming screw
342	2	8100-342-00	Compression spring
343	1	8100-343-00	Guide bracket
344	1	8100-344-00	Lifting rod
345	1	8100-345-00	Clamping piece
346	1	8100-346-00	Sliding piece
347	2	8100-347-00	Recessed-head screw
348	1	8100-348-00	Supporting disc
349	1	8100-349-00	Seal ring
350	1	8100-350-00	Shim
353	1	8100-353-00	Clamp screw
354	1	8100-354-00	Roller lever
355	1	8100-355-00	Guide roller
356	1	8100-356-00	Bearing pin
357	1	8100-357-00	Locking washer
358	1	8100-358-00	Straight pin
359	1	8100-359-00	Locking washer
364	2	8100-364-00	Needle roller
367	1	8100-367-00	Sticker
371	1	8100-371-00	Sintered-metal bushing
372	1	8100-372-00	Sintered-metal bushing
377	2	8100-377-00	Shim
653	1	8100-175-99	Silencer
811	1	8100-811-99	Assembly of service parts
840	1	8100-140-99	Gear cover asy
854	1	8100-203-99	Roller carrier
855	1	8100-204-99	Roller set
863	1	8100-166-99	Assembly of service parts
869	1	8100-260-99	Handle assy