

AXIAL NUT SOCKETS



A full range of ACTION impact sockets for axial nuts is now available from stock. Square Drive size ½" covers nut sizes KM02 up to KM08. Square Drive size ¾" covers nut sizes KM07 up to KM13. Square Drive size 1" covers nut sizes KM14 up to KM18.

These impact sockets can replace hook wrenches when working on bearing nuts and enable the use of impact wrenches.

½" AXIAL NUT SOCKETS

Type	T mm	D1 mm	D2 mm	d1 mm	L2 mm	L mm
DO69712530 GU06/30GU	4,5	46	30	38,5	6,5	55
DO69712725 KM6	4,5	46	30	34,5	9	82
DO69712730 KM6	4,5	53	30	41,5	9	82
DO69712740 KM8	4,5	81	30	53,5	9	82

¾" AXIAL NUT SOCKETS

Type	T mm	D1 mm	D2 mm	d1 mm	L2 mm	L mm
DO69714535 GU07/35GU	4,5	54	44	44,5	7	75
DO69714540 GU08/40GU	5,5	60	44	50,5	8,2	75
DO69714545 GU09/45GU	5,5	66	44	55,5	8,2	75
DO69714735 KM07/35KM	4,5	60,5	54	48,5	9	90
DO69714740 KM08/40KM	5,5	66,5	54	53,5	9	90
DO69714745 KM09/45KM	5,5	73,5	54	60,5	13,5	90
DO69714750 KM10/50KM	5,5	78,5	54	65,5	13,5	90
DO69714755 KM11/55KM	6,5	83,5	54	69,5	13,5	90
DO69714760 KM12/60KM	6,5	88,5	54	74,5	13,5	90
DO69714765 KM13/65KM	6,5	94	54	79,5	13,5	90

1" AXIAL NUT SOCKETS

Type	T mm	D1 mm	D2 mm	d1 mm	L2 mm	L mm
DO69715770 KM14/70KM	7,5	103	86	85,5	12	110
DO69715775 KM15/75KM	7,5	109	86	91,5	13	110
DO69715780 KM16/80KM	7,5	116	86	98,5	15	110
DO69715785 KM17/85KM	7,5	121	86	103,5	16	110
DO69715790 KM18/90KM	9,5	131	86	112,5	16	110

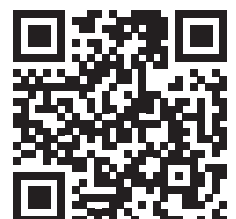
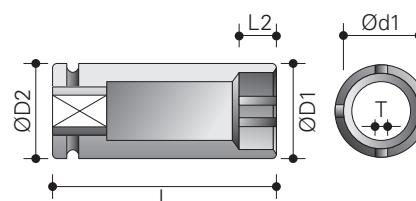

Scan QR code for the YouTube video.